

1. Synthetic Control Vial
2. QBC AccuTube™
3. QBC Pipettor (with AccuTube spacer)
4. Autoread Plus™ System (not shown)

### 1. Attach AccuTube Spacer

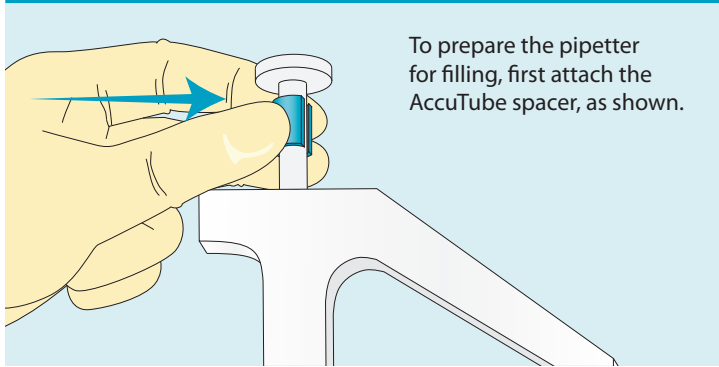

### 2. Insert Tube Into Pipettor

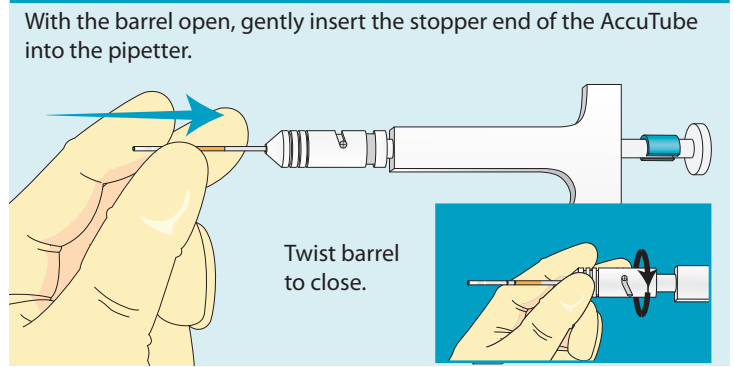

### 3. Shake Control Vial

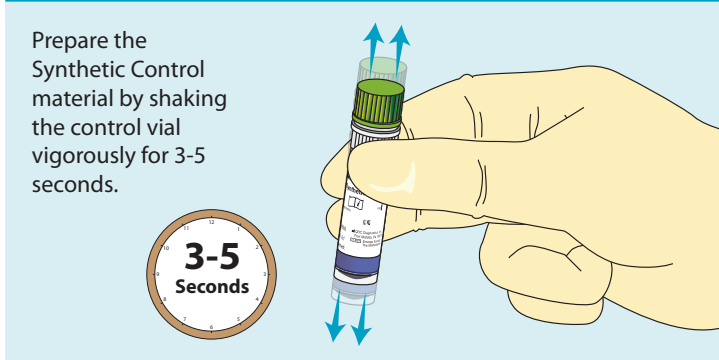

### 4. Invert Control Vial

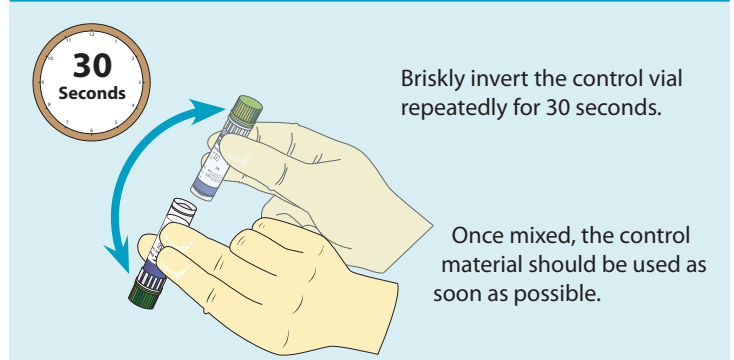

### 5. Fill Tube

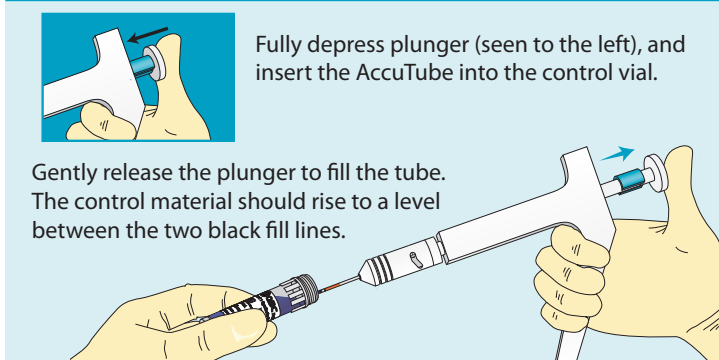

### 6. Remove Tube From Pipettor

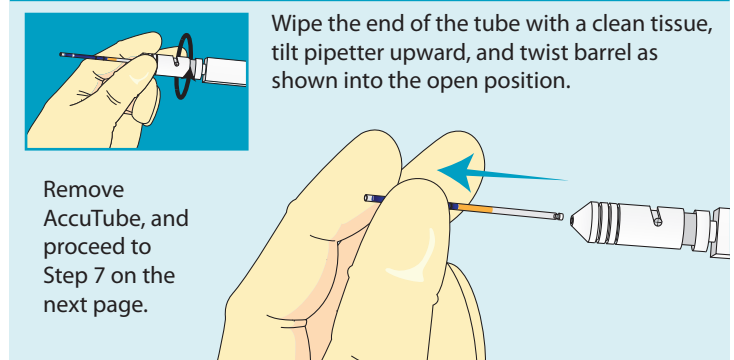

# User Guide: QBC Synthetic Hematology Control Kit

## 7. Rock 5 Times

Rock back and forth at least 5 times, moving the control material end-to-end to mix with the acridine orange coating.

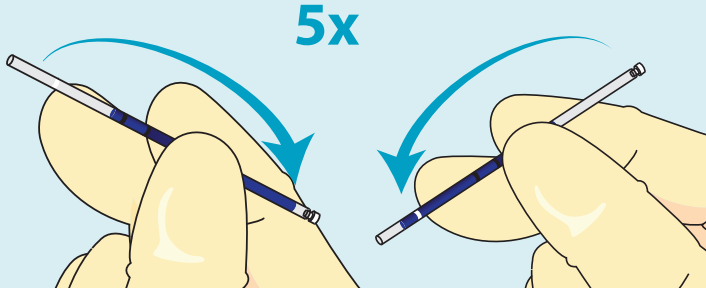

## 8. Seat Stopper

Turn AccuTube upright, and carefully press to a hard surface to seat stopper.

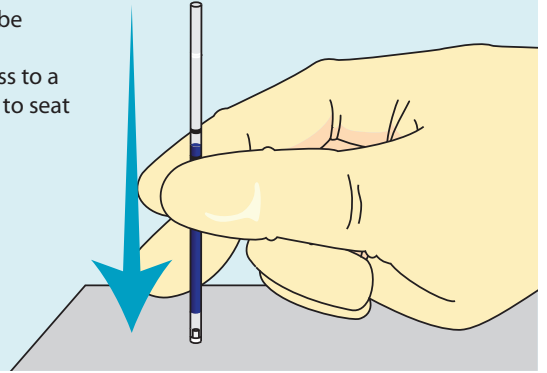

## 9. Insert Float

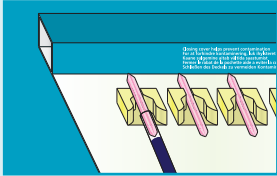

AccuTube floats are contained in soft grip holders inside the tube packaging.

To insert, slide the open end of the AccuTube over a float.

Gently lift the AccuTube up and out of the holder. Push the float against the back of the package to fully insert it.

Avoid touching the float with your bare fingers.

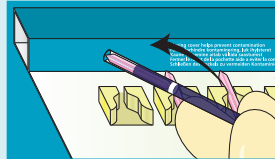

## 10. Centrifuge Tube

Open the lid of the QBC Capillary Centrifuge and remove the cover. Place the tube with the stopper end to the outside. Replace the cover and close the lid.

Tubes should be placed in a balanced array. If an uneven number of tubes is spun, an empty tube should be used for balance.

Run the centrifuge through its normal cycle.

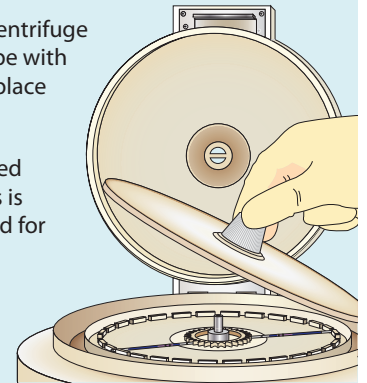

## 11. Insert Tube In Analyzer

Before inserting the tube into the Autoread Plus Analyzer, ensure that it is set to **CBC Mode**.

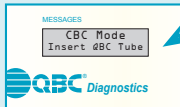

Open the lid of the Autoread Plus Analyzer and place the AccuTube, stopper end to the left, inside. Close the door to run the sample.

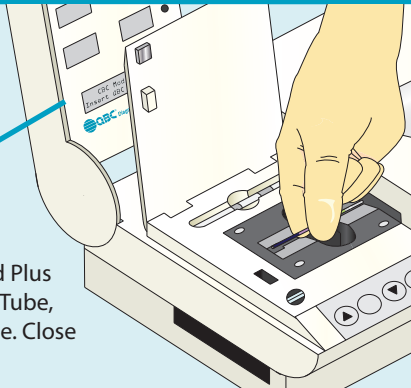

## 12. Obtain Results

Results are displayed and printed when test is complete. Review the results against the assay ranges included with the controls.

