

TUBE PREPARATION

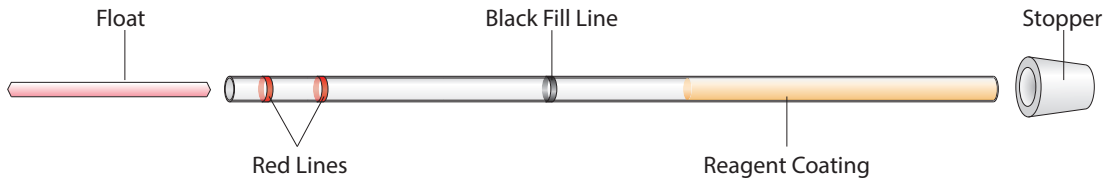

1. Place Tube in Pipetter

Open barrel of pipetter and hold in horizontal position. Insert end of tube nearest red fill lines into pipetter.

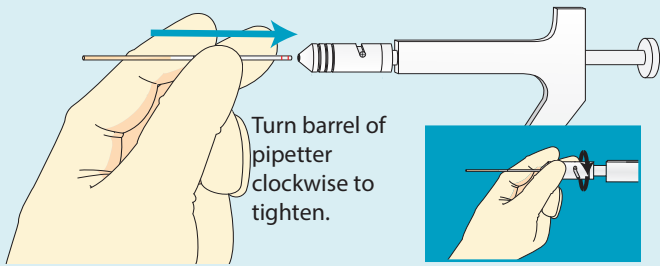

2. Fill Tube

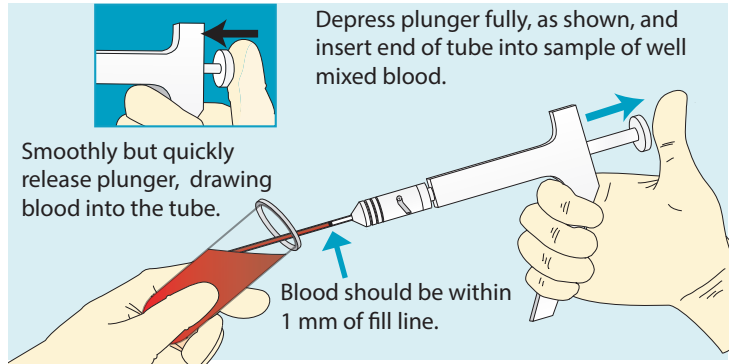

3. Seal Tube

Affix the stopper by hand, as seen below. Twist until stopper is sealed.

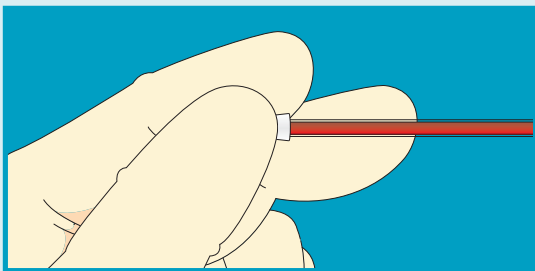

4. Roll Tube

Remove tube from pipetter. Gently roll between fingers at least 10 times to mix blood with acridine orange coating.

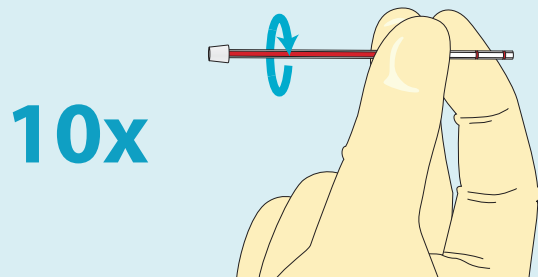

5. Insert Float

Using clean forceps, pick up a float from the test tray well.

Insert float into the unsealed end of the tube, and tap into the tube with the forceps.

DO NOT touch the float with your fingers.

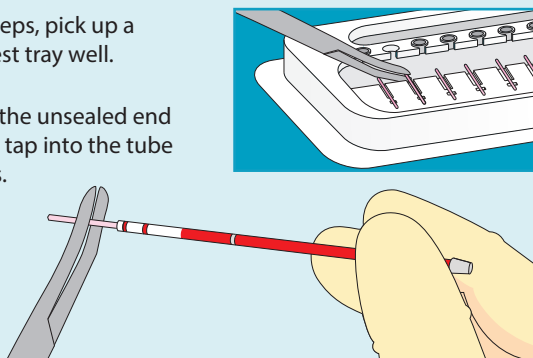

6. Read Results

Open the lid of the QBC Capillary Centrifuge and remove the cover. Place the tube with the stopper end to the outside. Replace the cover and close the lid.

Tubes should be placed in a balanced array. If an uneven number of tubes is spun, an empty tube should be added for balance.

Start the centrifuge and run for 5 minutes. You may now analyze the tube using the QBC AUTOREAD Plus[™] analyzer.

