

## TUBE PREPARATION

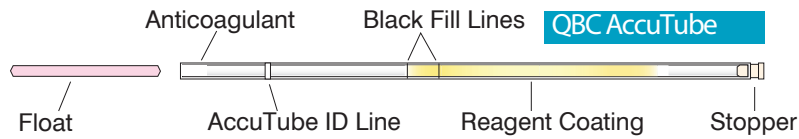

### DIRECT FILL

#### CAPILLARY BLOOD

**1** Hold tube close to horizontal. Fill between black lines. Avoid air bubbles. Proceed to step 2.

W I P E

#### VENOUS BLOOD

**1** Tilt well-mixed blood tube as shown. Place open AccuTube end in contact with blood. Fill to between black lines. Proceed to step 2.

W I P E

OR

### PIPETTER FILL

INSERT	FILL	REMOVE
<p><b>1a</b> With pipetter barrel OPEN, gently insert stopper end of AccuTube. Note: pushing forcefully will prematurely seat stopper. Twist barrel backward to CLOSE.</p> <p>Pipetter barrel in place.</p> <p>AccuTube spacer required.</p> <p>Keep pipetter OPEN when not in use.</p>	<p><b>1b</b> Depress plunger. Insert AccuTube into tube of well-mixed blood. Release to fill.</p> <p>W I P E</p>	<p><b>1c</b> Tilt pipetter upward. Twist barrel forward to OPEN, remove AccuTube. Proceed to step 2.</p>

#### ROCK 5 TIMES

**2** Rock back and forth at least 5 times. Move blood end-to-end to mix well with orange coating. Do not touch blood to stopper.\*

A+B=1 ROCK

#### SEAT STOPPER

**3** Turn AccuTube upright and press firmly to seat stopper.

#### INSERT FLOAT

**4** Slide open end of AccuTube over float to partially insert it. Gently lift AccuTube up and out of SoftGrip.

Push float against back of package to fully insert. Do not touch floats with fingers.

\*If blood stops moving, loosen or remove stopper and finish mixing. Reinsert stopper.

## CENTRIFUGATION AND READING

### CENTRIFUGE

- 5** Open lid, remove cover. Place AccuTube in centrifuge, stopper end out; balance. Replace cover, screw finger tight.
- Close lid, press ON/OFF button. Lid unlatches when centrifuge stops after 5 minutes.
- Open lid, unscrew cover and remove AccuTube.

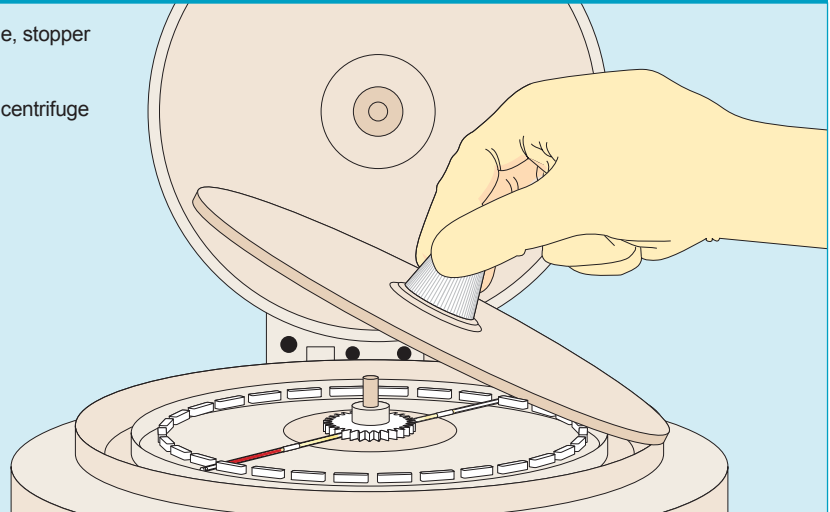

### TEST

- 6** Open lid and door. Place AccuTube in AUTOREAD Plus<sup>™</sup> analyzer, stopper end to left, close door. Analyzer automatically reads tube.

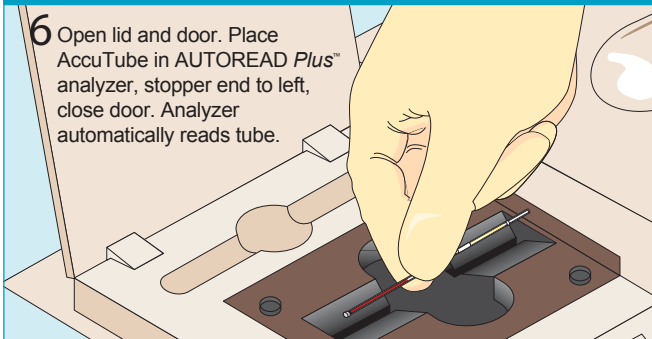

### OBTAIN RESULTS

- 7** Results are displayed and printed when test is complete. Open analyzer door, remove AccuTube.

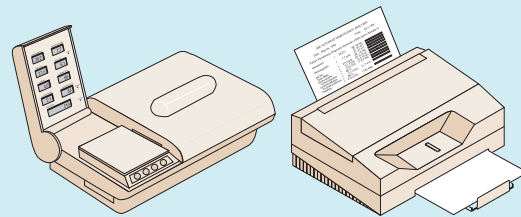

Discard tube in biohazardous sharps container.

See Operator's/Service Manual for further instructions.

### ACCUTUBE SPACER PLACEMENT

#### PUSH ON

Push spacer into place on pipetter plunger. Keep spacer in place when using pipetter with AccuTubes.

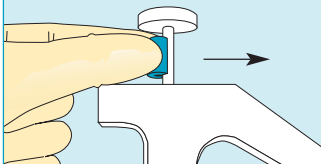

#### PUSH OFF

Push spacer off plunger for using pipetter with standard or E-Z Prep<sup>™</sup> tubes.

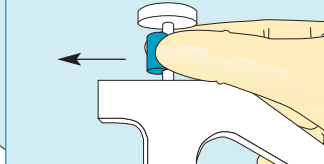

### PIPETTER BARREL REPLACEMENT

#### UNSCREW OFF

Unscrew tip or barrel from pipetter handle.

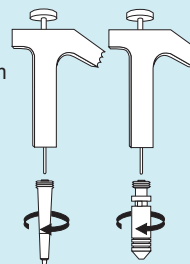

#### SCREW ON

Remove plastic twist lock, screw barrel into handle finger tight.



**NEED ASSISTANCE CALL TOLL FREE: 1.866.265.1486**