

1. Synthetic Control Vial
2. QBC AccuTube™
3. QBC Pipetter (with AccuTube spacer)
4. Autoread Plus™ System (not shown)

1. Attach AccuTube Spacer

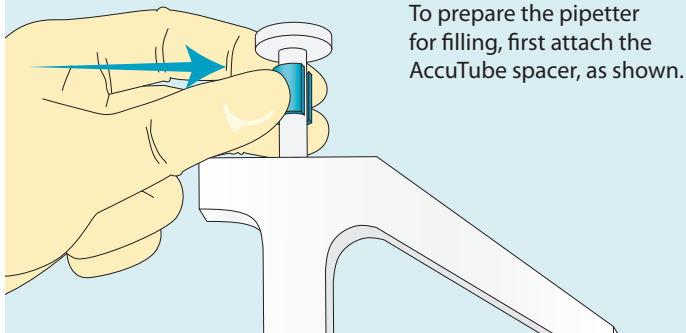

2. Insert Tube Into Pipetter

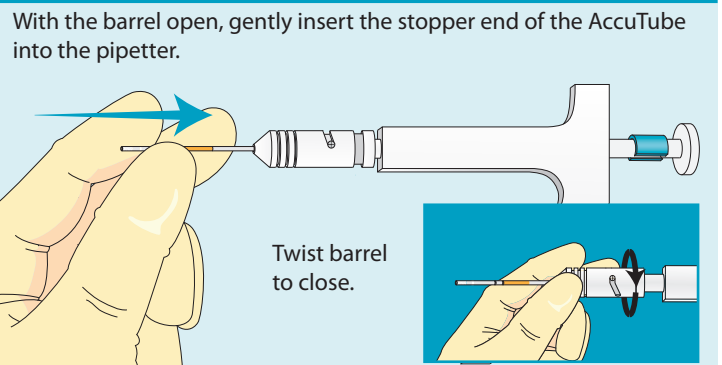

3. Shake Control Vial

Prepare the Synthetic Control material by shaking the control vial vigorously for 3-5 seconds.

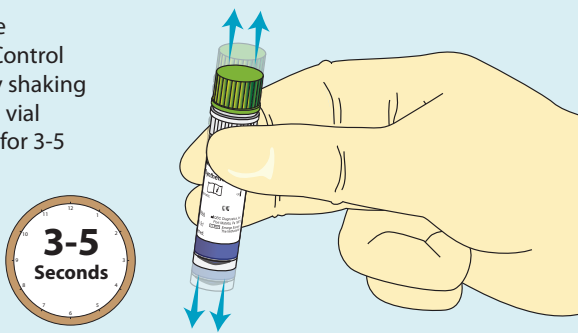

4. Invert Control Vial

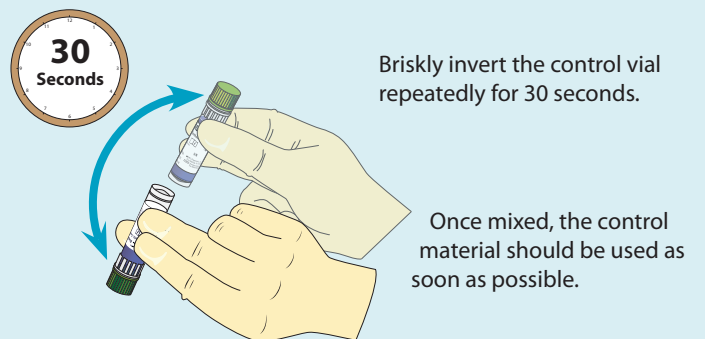

5. Fill Tube



Fully depress plunger (seen to the left), and insert the AccuTube into the control vial.

Gently release the plunger to fill the tube. The control material should rise to a level between the two black fill lines.

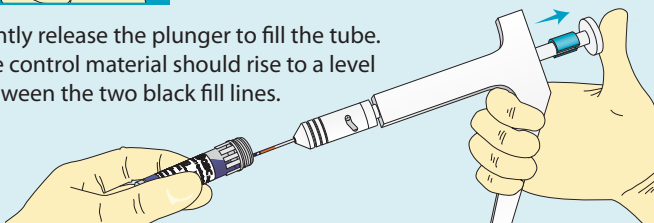

6. Remove Tube From Pipetter

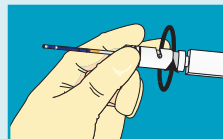

Wipe the end of the tube with a clean tissue, tilt pipetter upward, and twist barrel as shown into the open position.

Remove AccuTube, and proceed to Step 7 on the next page.

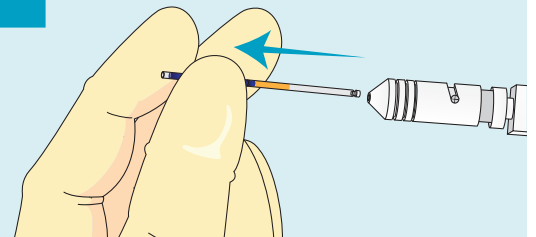

User Guide: QBC Synthetic Hematology Control Kit

7. Rock 5 Times

Rock back and forth at least 5 times, moving the control material end-to-end to mix with the acridine orange coating.

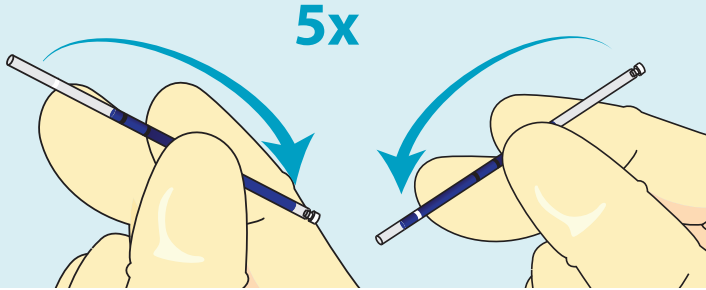

8. Seat Stopper

Turn AccuTube upright, and carefully press to a hard surface to seat stopper.

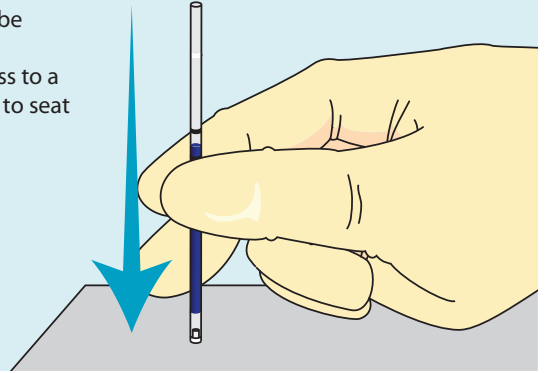

9. Insert Float

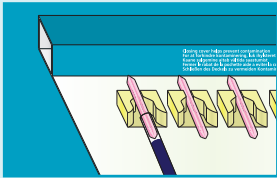

AccuTube floats are contained in soft grip holders inside the tube packaging.

To insert, slide the open end of the AccuTube over a float.

Gently lift the AccuTube up and out of the holder. Push the float against the back of the package to fully insert it.

Avoid touching the float with your bare fingers.

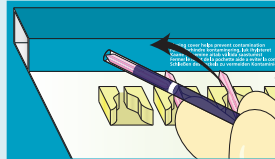

10. Centrifuge Tube

Open the lid of the QBC Capillary Centrifuge and remove the cover. Place the tube with the stopper end to the outside. Replace the cover and close the lid.

Tubes should be placed in a balanced array. If an uneven number of tubes is spun, an empty tube should be used for balance.

Run the centrifuge through its normal cycle.

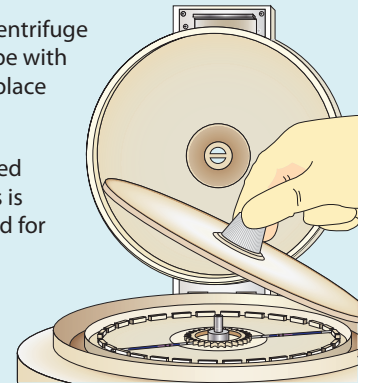

11. Insert Tube In Analyzer

Before inserting the tube into the Autoread Plus Analyzer, ensure that it is set to **CBC Mode**.

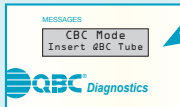

Open the lid of the Autoread Plus Analyzer and place the AccuTube, stopper end to the left, inside. Close the door to run the sample.

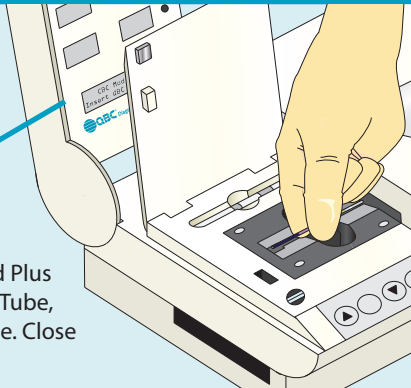

12. Obtain Results

Results are displayed and printed when test is complete. Review the results against the assay ranges included with the controls.

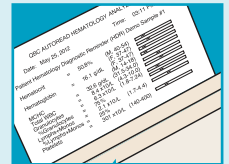
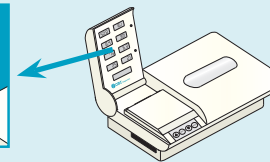

If you experience technical issues with the Synthetic Controls, please contact the QBC Diagnostics Technical Support team at

+1-814-692-7661 or qbcsupport@qbcdiag.com.